



NFC-500IL FIRE REMOTE INDICATOR INSTALLATION GUIDE

FEAURES	TECHNICAL DATA	
√ Highlight LED. √ Wall and Ceiling Mounting. √ Easy installation and connection. √ Low current consumption. √ High intensity LED for quick identification.	MODEL NUMBER	NFC-500IL.
	Max. Power Source	24V DC.
	Alarm Current @24V DC	12mA.
	Standby Current	0mA.
	Relative Humidity	95%
	Ambient Temperature	-10° C~+55°C.
	Indicator	Red LED.
	Material	ABS (Fire Proof Plastic).
	Color	White Surface \ Red Lamp.
	Weight	37gm.

MECHANICALS

- **Dimensions** : 120mmx 70mmx15mm.
- **Mount Style** : Surface mount with screw (2pcs).
- **Led Dia.** : 5mm.

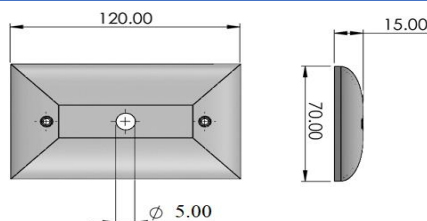

INSTALLATION AND PRECAUTIONS

Before Installation

Ensure that the power is turned off and the fire remote indicator must be installed in compliance with the control panel installation manual.

Device Installation

- Mount the indicator on a flat surface using provided screws.
- connect the positive and negative leads to the corresponding terminals on the fire alarm control panel.
- Secure the connections and restore power to the system.
- test the indicator for proper operation.
- Once all testing has been carried out on the cabling and continuity & insulation.
- Has been proven, NFC-500IL can be connected.

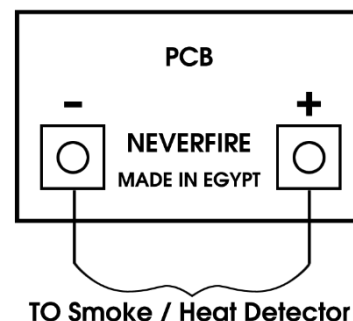

TECHNICAL SUPPORT AND MAINTENANCE INSTRUCTIONS

- Due to the complexity and inherent importance of a life risk type system, Training on the equipment is essential and commissioning should be carried out by competent persons.
- Ensure that the detector connected to the Remote Indicator is adjusted into the fire state to ensure that the LED operates successfully.

For Maintenance

you should keep your device as the following:

- Regular inspect the indicator for dust and debris.
- Clean with a dry cloth as needed.
- Check connections periodically to ensure reliability.